



CHI FENG

# PRODUCTS CATALOG

While we may not manufacture the finish product, we stand as a professional component factory supporting global medical giants. We offer a variety of service solutions, forging a partnership with each other.



**LET OUR TEAM , BE YOUR TEAM !**

Chi Feng Co., Ltd. Copyright 2024. All rights reserved.



# To improve better Healthcare environment

## Commitment and Faith

At Chi Feng, our dedication to advancing medical care is reflected in our precision engineering and innovative needle-free solutions.



## Expertise and Passion

Our expertise and passion drive us to improve safety and quality in the healthcare industry.

## Cross-industry Collaboration

Global healthcare leaders choose Chi Feng for our innovations and shared vision of enhancing medical care.

## Enduring Mission

For over 30 years, we have remained committed to creating a safer, more efficient healing environment.



## About Us

Chi Feng Co., Ltd., founded in 1988, focuses on plastic injection and medical consumables, including patented needleless connectors and chemotherapy preparation systems.

As a trusted global supplier, we offer mold design, manufacturing, and assembly in ISO 13485:2016 certified cleanrooms, ensuring top-quality from materials to delivery.







## Luer System

### "Ensuring Safe Handling of Chemotherapy Drugs with Advanced Equipment"

Long-term exposure to chemotherapy drugs presents health risks, not only to patients but also to individuals involved in their administration. For pharmacists and healthcare professionals, it is paramount to take precautions against these potential hazards.

The closed male luer system has been specifically engineered to protect healthcare workers from the adverse effects of highly toxic medications. Its primary function is to secure the liquid flow within the tube, preventing the escape of chemotherapy drugs.

Furthermore, the inclusion of a spike with a needleless connector plays a pivotal role. This feature guarantees that, even in the event of accidental knock-over, there will be no spillage from the drug bottle. As a result, it greatly reduces the likelihood of medical staff coming into direct contact with the drug, effectively preventing potential infections.

Lastly, Chi Feng's drug preparation system boasts a diverse range of luer connectors, each designed to cater to specific applications. This enhances the adaptability and efficiency of the system.

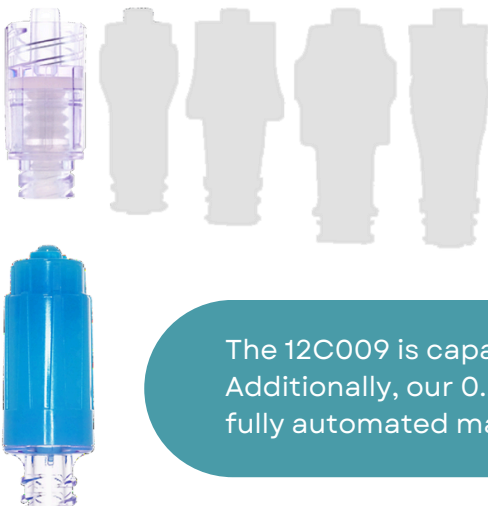
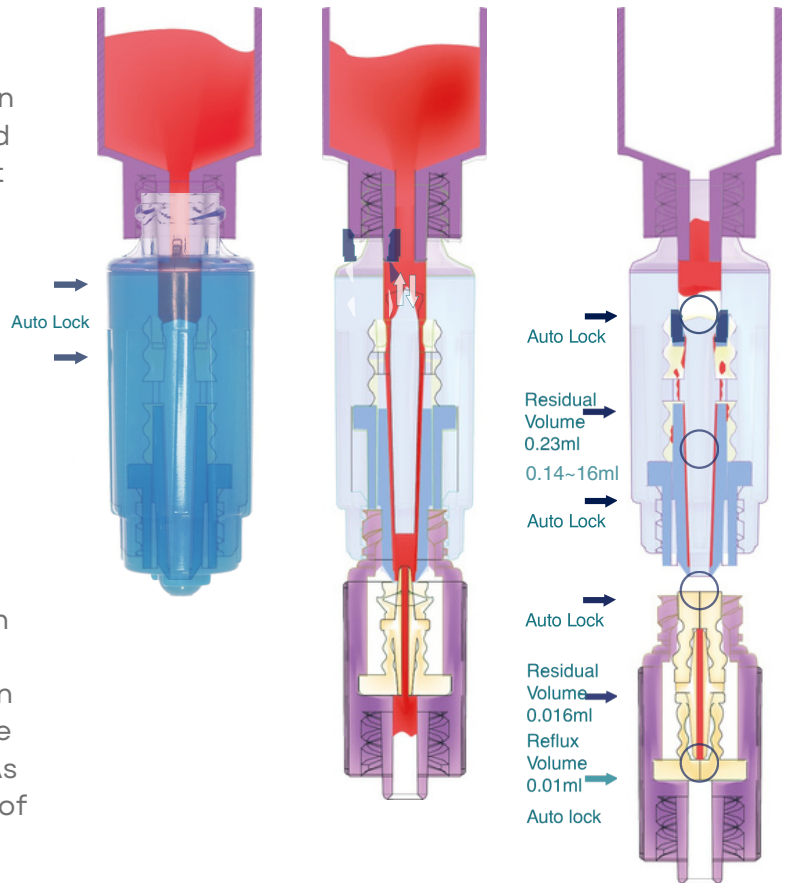

The 12C009 is capable of connecting with other needleless connectors. Additionally, our 0.2um vented vial adapter is seamlessly assembled by our fully automated machine, ensuring 100% accuracy.



## QuikLock System: Quick to Lock

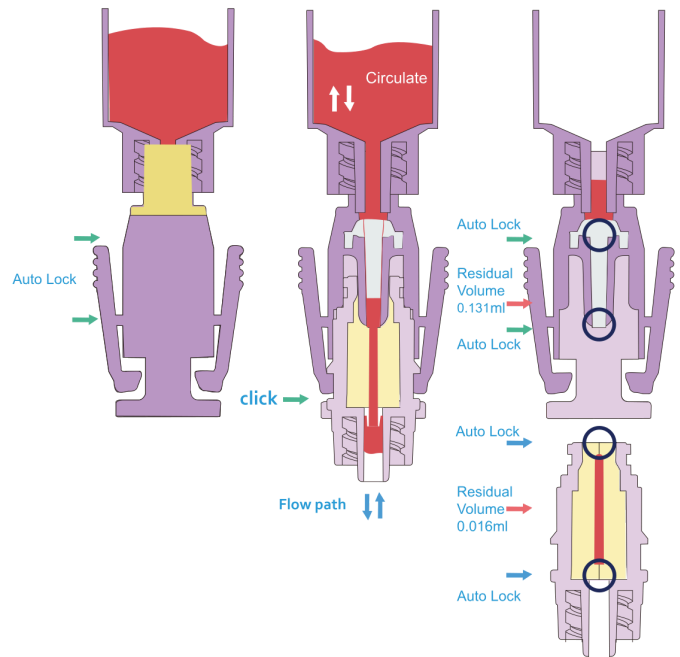

### QUIK LOCK Closed Male Luer

Medical grade materials

**Functional activation** up to 100 times

**Flow rate** 100mL/ min  
(When connect Quick Click Gen2)

**Back Pressure** 50psi

**Residual Volume**  
0.132 mL (inside connector only)



### QUIK LOCK Gen2 Needleless

Medical grade materials

Neutral pressure

**Functional activation** up to 100 times

**Flow rate** 100mL/ min  
(When connect Quick Click Gen2)

**Back Pressure** 50psi

**Residual Volume**  
0.016 mL (inside connector only)

### Drug compatibility

75% Alcohol Yes  
20% Lipid yes

### Sterilized method depend on customer

EtO, Gamma

### Regulatory Affairs Product Information

ISO 80369-7 Male and female luer slip connectors and luer lock connectors.  
ISO 10993-1 Biocompatibility test



# CSTD (Closed System Transfer Device) Quik Lock, How To Use?



## QuikLock CML (Closed Male Luer)

**connect on the syringe**



**20C002**  
QuikLock  
CML with cap



**21C006**  
QuikLock  
Closed male luer



**20C005**  
QuikLock  
Gen2 with vial  
adapter 13mm



**20C006**  
QuikLock  
Gen2 with vial  
adapter 20mm

**21C009**  
QuikLock  
Gen2 with vial  
adapter 0.2um filter

## QuikLock Gen2 vial adapter

**connect on the vial**



## QuikLock CML connect with Gen2 vial adapter to take the drug from vial to the syringe

When drawing medication, ensure the vial is positioned above the syringe to allow gravity to aid liquid flow, preventing air bubbles and ensuring safe handling.



## QuikLock CML connect with Infusion Spike

**to push the drug from syringe to the IV bag**



**21C008**  
QuikLock Infusion Spike



## QuikLock Infusion Spike can connect with IV Set

Before connect, please turn off the roller clamp by IV set.





# QuikLock

## Bladder Perfusion Connector

A Safe Connection Solution for Bladder perfusion applications.



The QuikLock bladder perfusion connector is designed for bladder perfusion applications, offering several advantages such as time-saving operation, leak-proof medication transfer, and no need for tube bending.

The procedure for intravesical chemotherapy involves administering anticancer drugs through a urinary catheter into the bladder via the urethra. After administration, the catheter is removed, allowing the medication to remain in the bladder for a specific duration. The primary goals of this method include eliminating residual bladder tumor cells that may not have been removed during previous treatments, preventing tumor recurrence, and inhibiting the progression of cancer to deeper tissue layers.

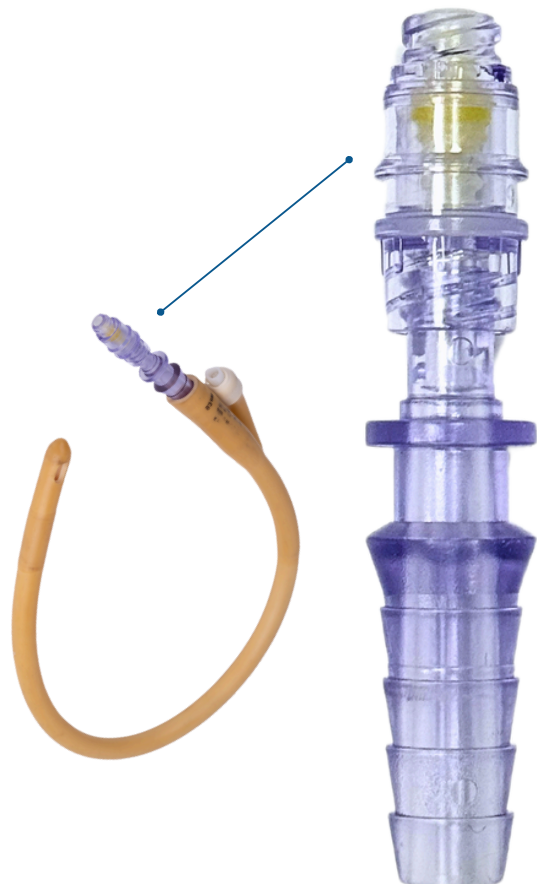

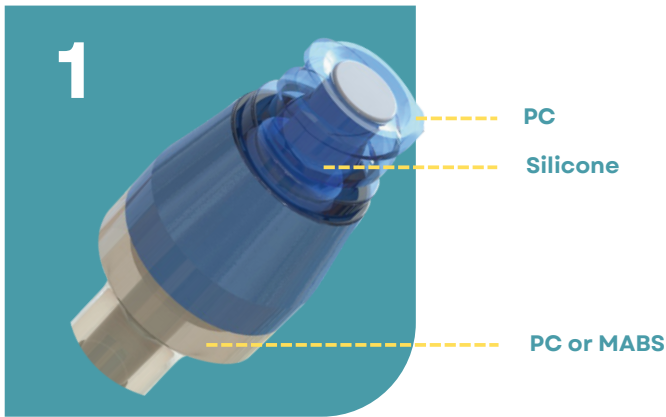

- **Simple structure**, this product made up from only three components. Significantly reduce the chance of failure.

2



- **Comply with ISO 594 / 80369-7 standard** it can connect with any other products that is comply with this regulation.

3



- **Easy to disinfect** the connector, and has no residual on the hub of it.

4



- **High pressure resistant**  
It can resist the pressure from infusion, up to 7kg/cm<sup>2</sup>.

# Gen1 Needleless Connector

## Medical grade materials

Negative pressure

Functional activation up to 200 times

Flow rate 150mL/ min

Back Pressure 70psi

Pressure Maximum 325psi

Residual Volume

0.3 mL (inside connector only)



## Drug compatibility

75% Alcohol Yes

20% Lipid yes

## The sterilized method depends on the customer

EtO, Gamma (Not applicable to 17C012)

## Regulatory Affairs Product Information

ISO 80369-7 Male and female luer slip connectors and luer lock connectors.  
ISO 10993-1 Biocompatibility test





## Neutral Pressure

Sealed  
Interstitial Space

Easy to clean  
swabable  
surface

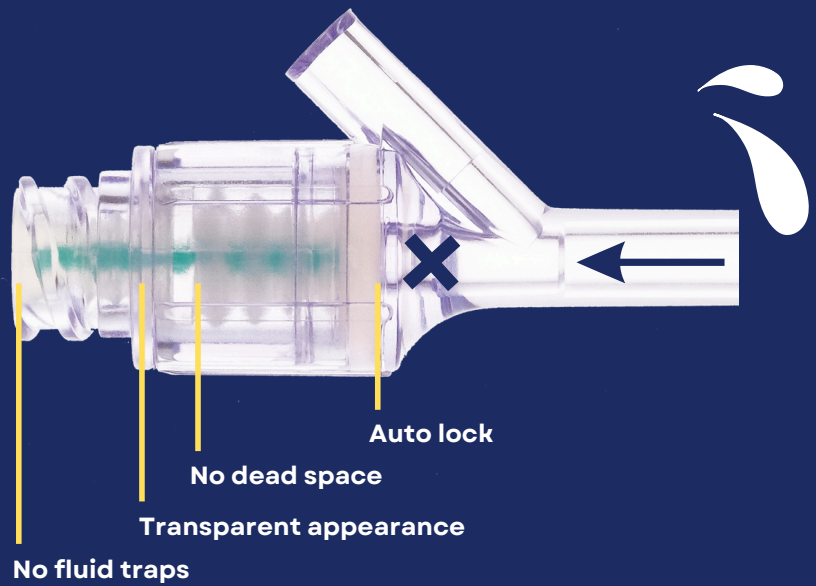

# Gen2 Needleless Connector

**Medical grade materials**

**Neutral pressure**

**Functional activation** up to 200 times

**Flow rate** 120~145mL/ min

**Back Pressure** 40~70psi

**Pressure Maximum** 140~300psi

**Residual Volume**

0.016 mL (inside connector only)



### Drug compatibility

75% Alcohol Yes

20% Lipid yes

### The sterilized method depends on the customer

EtO, Gamma (Not applicable to  
17C012)

### Regulatory Affairs Product Information

ISO 80369-7 Male and female  
luer slip  
connectors and luer lock  
connectors.

ISO 10993-1 Biocompatibility test

# Gen2 Zero

## Anti-Reflux Neutral Double Closed Needle-free connector



### Protecting Your Health!

Gen2Zero is designed to prevent needle-stick injuries, reduce infection risk, and eliminate concerns over blood residue.

What once caused line blockages from a patient's arm movement is now effortlessly avoided, thanks to Gen2Zero acting like an intelligent hand to keep everything running smoothly, ensuring peace of mind.

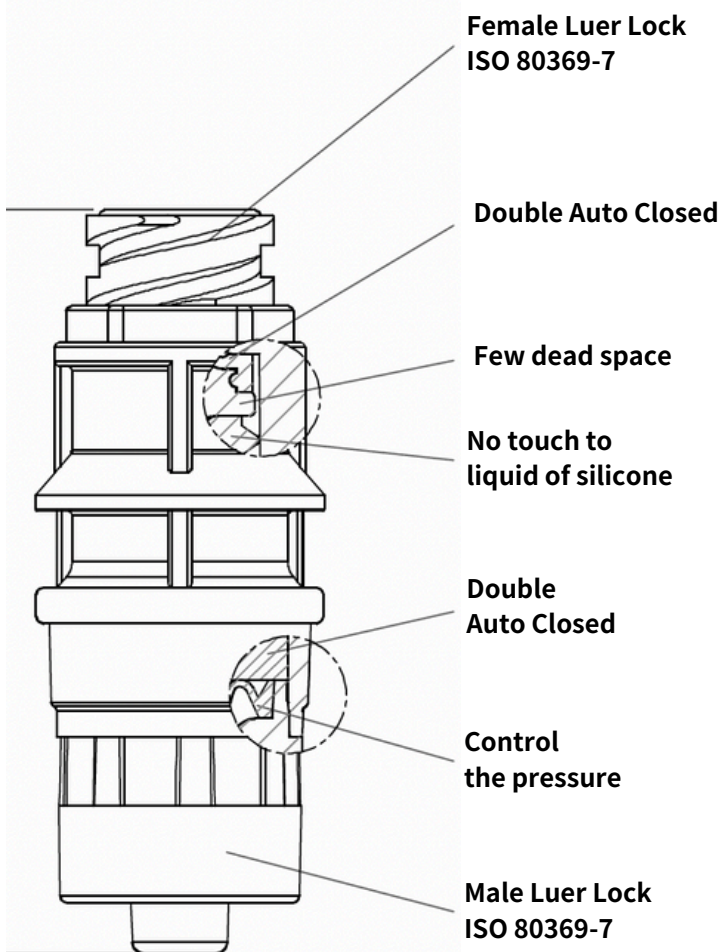

Comply with the  
ISO 594, ISO 80369-7  
standards, and can  
comply with most  
other infusion products.



Transparent  
appearance, easy to  
visualize the fluid path  
and to operate.



The swabable surface  
design fits most clinical  
practices, easy  
to swabbed and no  
residual on the surface.



# PINCH LOCK

A Safe Connection Solution for IV Infusion



**PINCHLOCK** is an innovative IV infusion connector designed to improve patient safety. Its rotating function prevents tubing kinks caused by movement, while a safety lock ensures disconnection only at the correct position, reducing accidental disconnections and providing greater peace of mind during treatment.



Non-rotating connector may be able to tubing kinks.



Rotating funtion that effectively prevents tubing kinks.



Very easy to connect on the female part.



Touch here to remove the connection.





# VIAL ADAPTER

## Innovative Solution for Safe Liquid Extraction

**Purpose:** The Vial Adapter is an innovative device designed to safely extract liquids from vials without the need for traditional needle puncture. By eliminating the risk of needle-stick injuries, it ensures the safety of users during the transfer process.

It serves as a secure bridge for drawing medication into a syringe, facilitating a smooth and safe workflow. **Applications:** The Vial Adapter is highly suitable for aesthetic applications, especially for precise extraction of valuable substances like hyaluronic acid or exosomes. Additionally, it can be used in medical settings for safely extracting medication from vials.



We have many types of vial adapters.



Position the vial above the syringe to use gravity, reducing air bubbles for safer handling.



We have vial to vial adapter.



# Safe D&R™

Force-Activated Separation Device



When using IV therapy on animals, activate our connectors to ensure proper separation and prevent leakage. Our connectors securely connect and offer versatile infusion options with an integrated design for easy attachment during treatment.

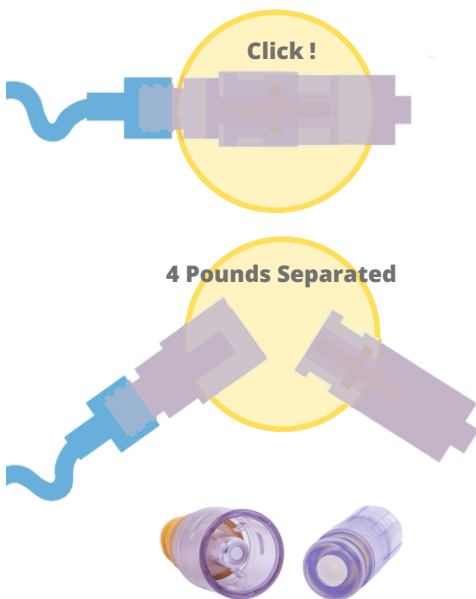

## Back Pressure

Male site 32psi (Average)  
Female site 40psi (Average)

## Surface Residue

0.00032g

## Separation Force

- 2 to 5 pounds module

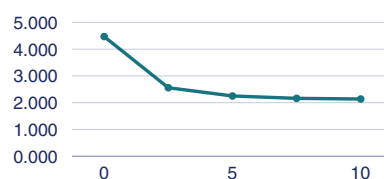

## Residual Volume

Male site 0.162ml (Average)  
Female site 0.003ml (Average)

## Flow Rate

145~153 ml/min (Average)

- 1 to 2 pounds module



Doesn't contain any materials in below : • Latex Free • PVC Free • Non-animal sources

Our SafeD&R has global patents, which is protected by intellectual property rights and patents. Patented. Any infringement will be legally pursued.



## CTLock – A Safe Needle-Free Solution for High-Pressure CT Syringes in MRI Infusions

# CTLock

CTLock is an innovative product specifically designed for high-pressure CT syringes used in MRI infusion applications. Due to the need for higher pressures, the syringe tip design deviates from the conventional ISO 80369-7 standard. In response to this demand, we developed a high-flow needle-free connector, known as CTLock, ensuring that the entire infusion system remains needle-free and safe even under high pressure, providing enhanced safety and convenience for both patients and users.



**CTLOCK SET ON CT SYRINGE.**



**Normally needle free connector can't connect on it.**



**CTLock can connect on it, and easy to use.**



**WE HAVE TWO TYPES**

Luer lock and straight type.



## Male Luer Series



**12A775**  
Male luer cap



**20A039**  
Male luer cap vented



**19C003**  
Rotating Male luer  
for 3.9mm tubing



**20A038**  
Male luer adapter  
for 4mm tubing



**12A992**  
Male luer slip  
for 4mm tubing

**16C009**  
(2 parts)  
Male luer adapter  
for 4mm tubing

**20C015**  
(2 parts)  
Male luer adapter  
for 4mm tubing

**19C004**  
Rotating Male luer  
for 3.5mm tubing  
(Without male luer cap)

**18A147**  
Big Male luer adapter  
for ID8.8mm and  
OD7mm tubing

**13A017**  
Male luer slip with wing  
for 3.9mm tubing

**16C010**  
(2 parts)  
Male luer adapter  
for 2.3mm tubing

**20C016**  
(2 parts)  
Male luer adapter  
for 2.3mm tubing

**17A057**  
Male luer adapter  
for 2.3mm tubing

**15A098**  
Male luer slip  
for 2.3mm tubing

## Female luer Series



**20A046**  
Female luer Y for 2.3mm tubing

**20A045**  
Female luer Y for 2.6mm tubing

**22A090**  
Female luer Y with male luer slip

**20A044**  
Female luer Y for 4mm tubing

**24C023**  
Female luer Y connector with  
rotating MLL, FL/FL/MLL



**19A037**  
Female luer lock for 2.6mm tubing

**17A085**  
Female luer lock for 2.3mm tubing

**17A078**  
Female luer lock for 4mm tubing

**17A069**  
Female luer lock for 3.15mm tubing



**17A075**  
Female luer cap non-vented

**15A045**  
Female luer cap vented



**12A882**  
Pinch clamp 6~8mm tubing (white)

**17A073**  
Pinch clamp 2.3~4mm tubing (white)

**11A074**  
Pinch clamp 2.3~4mm tubing (yellow)



Other color or material please contact us

## Pinch clamp

## Double luer Series



**23C023**  
Male to Male  
luer lock connector



**22A016**  
Female to Female  
luer lock connector



**19B002**  
Roller clamp for 4mm tubing

**12C606**  
Big roller clamp for 6~8mm tubing



**17A083**  
Slide clamp for 2.3mm tubing

**10A001**  
Slide clamp for 4mm tubing

## Roller & slide clamp series

## Gen1 needle free connector (Negative)



**11C009**

Gen1 luer connector



**11C001**

Gen1 Y connector  
for 4mm tubing



**11C013**

Gen1 Y connector  
for 3mm tubing



**13C002**

Gen1 Y connector  
for 2.3mm tubing



**11C005**

Gen1 standalone  
for 4mm tubing



**11C017**

Gen1 standalone  
for 2.3mm tubing



**14C001**

Gen1 standalone  
for OD4.4mm  
for ID6.8~7.2mm



**14C010**

Gen1 luer slip



**15C002**

Gen1 T port  
for 6.8mm tubing



**13C013**

Gen1 burette cap  
non assemble filter



**15C007**

Gen1 with mini  
vial adapter  
0.2um filter



**18C049**

Gen1 T connector  
for 2.3mm tubing

## Gen2 needle free connector (Neutral)



**14C007 / 16C002**

Gen2 connector  
normal / high  
pressure



**13C001**

Gen2 T connector  
luer slip



**18C024**

Gen2 connector  
for chemo use



**11C024 / 16C007**

Gen2 standalone  
for 2.3mm tubing  
normal / high  
pressure



**11C025 / 16C008**

Gen2 standalone  
for 4mm tubing  
normal / high  
pressure



**22C030**

Gen2 rotating luer  
T 4mm tubing



**18C027**

Gen2 Y connector  
for 3.8mm tubing



**13C015**

Gen2 Y connector  
for 2.3mm tubing



**16C004**

Gen2 Y connector  
for 4mm tubing

**22C031**  
Gen2 rotating luer  
T 2.3mm tubing

## High flow rate Needle free connector



**23C031**

High flow rate  
needle free connector  
standalone 4mm



**23C001**

High flow rate  
needle free  
connector



**24C014**

CTLockNeedle free  
connector for CT  
Syringe



**24C043**

3 way stopcock with  
high flow rate needle  
free connector



**24C043**

3 way stopcock with  
high flow rate needle  
free connector

## Gen2Zero

## QuikLock series



**20C002**  
QuikLock  
CML with cap



**21C006**  
QuikLock  
Closed male luer



**21C007**  
QuikLock  
Closed male luer  
(Rotating)



**20C004**  
QuikLock  
Gen2 connector



**20C005**  
QuikLock Gen2  
with vial adapter  
for 13mm



**20C006**  
QuikLock Gen2  
with vial adapter  
for 20mm



**21C008**  
QuikLock  
Infusion Spike



**21C009**  
QuikLock  
Gen2 with vial  
adapter 0.2um  
filter



**24C051**  
QuikLock  
Gen2 connector  
(Blue)



**24C052**  
QuikLock  
Gen2 connector  
(Green)



**24C053**  
QuikLock  
Gen2 connector  
(Red)



**24C054**  
QuikLock  
Gen2 connector  
(Orange)



**24C055**  
QuikLock  
Gen2 connector  
(White)

## Closed male luer



**12C009**  
Closed male luer



**18C023**  
Closed male luer

## Vial adapter series



**18A196**  
Vial adapter  
for 13mm vial



**18A195**  
Vial adapter  
for 20mm vial



**13B002**  
Vial adapter universal  
with 0.2um filter



**18C034**  
Mini vial adapter  
with 0.2um filter



**14B002**  
PIN Spike 12mm

## Spike series



**22C029**  
Infusion Spike for  
big rate non vented



**16C011**  
IV Spike with luer and vented

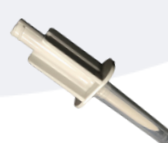

**18C044**  
IV Spike non vented



**22C005**  
Vented Hyperal Piercing  
Spike with cap



## CF QuikLock (CSTD)



**24C045**  
CF QuikLock  
Check Valve  
2.3mm (WH-NA)



**24C049**  
CF QuikLock  
Check Valve  
2.3mm (WH-G)



**24C048**  
CF QuikLock  
Check Valve  
2.3mm (WH-Y)



**24C047**  
CF QuikLock  
Check Valve  
2.3mm (WH-R)



**24C046**  
CF QuikLock  
Check Valve  
2.3mm (WH-B)



**24C064**  
CF QuikLock  
Check Valve  
2.3mm (R-NA)



**24C066**  
CF QuikLock  
Check Valve  
2.3mm (O-NA)



**24C063**  
CF QuikLock  
Check Valve  
2.3mm (B-NA)



**23C054**  
CF QuikLock CML

**23C055**  
CF QuikLock CML  
(Rotating)



**24C057**  
CF QuikLock  
3 way Stopcock Luer  
Lock with cap

**24C056**  
CF QuikLock  
3 way Stopcock Luer  
Lock without cap

**24C037**  
CF QuikLock  
3 way Stopcock Luer Slip  
without cap

## 3 ponds FASD



**23C028**  
3 ponds FASD  
Closed male luer



**23C029**  
3 ponds FASD  
Gen2 connector



**24C030**  
PinchLock Male luer lock  
(Rotating) for 4mm



**24C062**  
PinchLock Male luer lock  
(Rotating) for 2.3mm

## PINCH LOCK Male luer Lock



# 騏峰塑膠股份有限公司 Chi Feng CO., Ltd.

## CONTACT US

Ms. Pei Tsai  
pei@e-elect.com.tw

Mr. Kevin Tsai  
Kevintsai@e-elect.com.tw

[www.chifeng-medical.com](http://www.chifeng-medical.com)

